



Clifford Gardens, NW10

TO LET - £2,400 Per Month

AVAILABLE NOW- This lovely Garden flat, located in Clifford Gardens. The property boasts a bright reception room, separate kitchen with fitted appliances, a separate dining area (currently used as a second bedroom), a double bedroom with built in storage serviced by a three piece bathroom. The 35 ft rear garden also includes shed space perfect for storage.

Clifford Gardens is located on a tree-lined street, offering easy access to Chamberlayne Road with a selection of eateries, deli's and coffee houses. Excellent transport links into Central London include Kensal Rise (Mildmay Zone 2) and Kensal Green (Lioness, Mildmay & Bakerloo Zone 2).

- 2 bedroom Garden flat
- 35 ft rear garden
- Close to local amenities on Chamberlayne Road
- Excellent transport links into Central London
- DEPOSIT: £2,769
- COUNCIL: Brent (D)



020 7328 2828

rentals@cameronsstiff.co.uk

cameronsstiff.co.uk

Clifford Gardens, NW10

Approx. Gross Internal Area = 60.0sqm / 645.8sqft

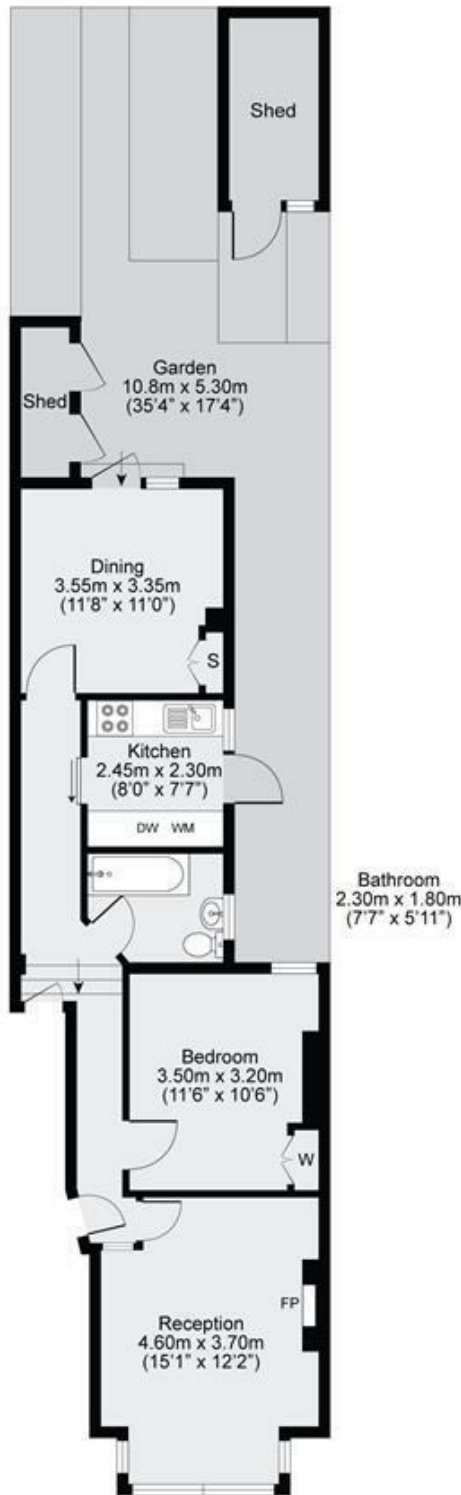
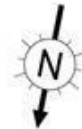

Ground Floor

EPC: C

Ref: 19614895

Disclaimer: Floorplan measurements are approximate and are for illustrative purposes only. While we do not doubt the floorplan accuracy and completeness, you or your advisors should conduct a careful, independent investigation of the property in respect of monetary valuation.

